



## Red Gum Studios Price List

(Prices effective January 1 2020)

| Quick Look Index         | size       | 10 hr   | Pre-ordered<br>12 hr | pg. |
|--------------------------|------------|---------|----------------------|-----|
| STAGE A                  | S          | \$400   | \$500                | 7   |
| STAGE B                  | M          | \$600   | \$750                | 8   |
| STAGE C                  | L          | \$1,000 | \$1,250              | 9   |
| STAGE B+C                | XL         | \$1,500 | \$1,900              | 9   |
| <b>CAMPUS</b>            | <b>XXL</b> |         | <b>\$2,000</b>       | 3   |
| <b>CAMPUS +<br/>GEAR</b> |            |         | <b>\$3,000</b>       | 3   |
| EVENT                    |            |         | \$3,000+             | 3   |
| WET STAGE                | POOL       | CALL    | \$2,500              | 4   |

### CAMPUS

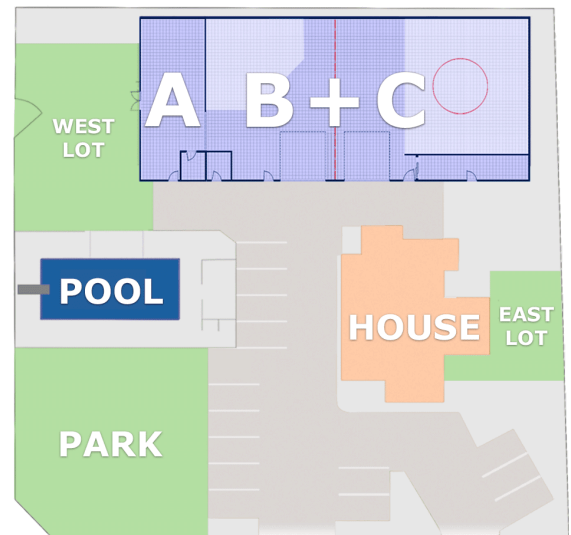

Included: A/C, Heat, Basic Wi-Fi, 1 table & 4 chairs.

|                                 |       |
|---------------------------------|-------|
| Add-ons (requires stage rental) | Pg. 4 |
| HOUSE                           | \$250 |
| BACK LOT WEST                   | \$200 |

|      |       |
|------|-------|
| CREW | Pg. 4 |
|------|-------|

|                                       |      |
|---------------------------------------|------|
| Specialty GEAR (see page for pricing) | Pg.5 |
|---------------------------------------|------|

Automotive Carousel  
Flying Flat or Lightbank  
Lighting Truss  
Set Pieces, Wall Flats  
Green Screens / Black-out  
GEAR Packages

Pg. 6

Red Gum Studios 2983 E. Miraloma Ave. Anaheim, Ca 92806  
Darin Dormeyer [darin@redgumstudios.com](mailto:darin@redgumstudios.com) mobile/text (714) 458-7003



## Rental Requirements

10 Hour Day: 8am-6pm Monday-Friday.  
12 Hour Day: Early / Late Start Included\*

Over-time: 1.5x after 10 hours\*  
2x after 12 hours\*  
12 hr. Day Pre-ordered Discount Price listed.

Weekends: \$1,000 minimum\*

|           | Reserved Parking                          | Maximum Participants |
|-----------|---|----------------------|
| STAGE A   | 2   | 7                    |
| STAGE B   | 4   | 14                   |
| STAGE C   | 6   | 20                   |
| STAGE B+C | 10  | 34                   |
| CAMPUS    | ALL Parking 12+<br>Double parking allowed |                      |

- **General Liability Insurance Certificate** with Red Gum Studios and Don & Mary Dormeyer as co-insured. (1 million for stills / 2 million for film and events).
- Signed Rental Agreement (pg 12).
- 30% Non-Refundable Reservation Fee (deposit) required to reserve dates for all rentals. This fee is non-transferable and is applied to your balance. Rentals canceled 48 hrs. in-advance will lose their deposit, but will not be charged their remainder. Rentals canceled less than 48 hrs. before the first day of rental will be charged in full.

\*subject to availability.

Red Gum Studios 2983 E. Miraloma Ave. Anaheim, Ca 92806  
Darin Dormeyer [darin@redgumstudios.com](mailto:darin@redgumstudios.com) mobile/text (714) 458-7003



## CAMPUS Package

### **CAMPUS**

**\$2,000**

STAGE A, B+C,  
BACK LOTs  
HOUSE  
12hr. Day  
Privacy & Control over access  
All parking spaces (double parking allowed)  
Unique door code on request  
200 amps.

\$1,000+ savings\*\*

(Paint, Pool use, and Labor NOT INCLUDED)

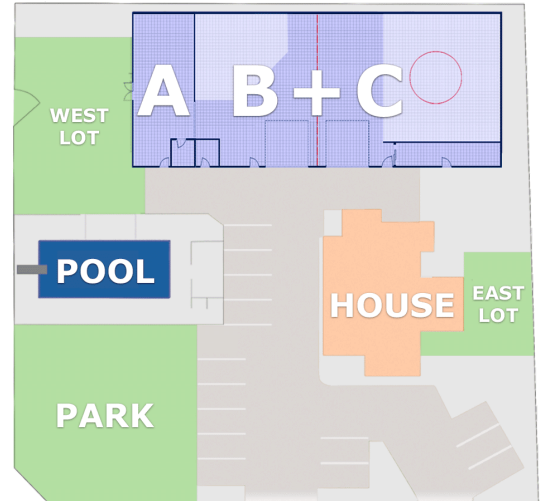

### **CAMPUS + GEAR Package**

**\$3,000**

Campus  
In-ground Automotive Carousel.  
"Bank Mover". Overhead Bridge Crane  
Flying Flat / Light-bank  
Large + Small ARRI Lighting Kit  
2 Ton Grip  
LED Package  
Flash Package  
Production Package

\$3,000+ savings\*\*

(Paint, Labor, Pool use, Expendables, Green Screen &  
Black-out packages NOT INCLUDED)



### **Event Package**

**Starting at \$3,000**

Private Campus (Pool use NOT INCLUDED)  
Basic Event Lighting

\*\*compared to a la carte pricing.

B+C with Event Lighting + Carpeting





## Add-ons

(Require Stage Rental. On-site use only.)

### **HOUSE**

#### Full Kitchen

Refrigerator/Freezer/Ice-maker.

Stove, Cooktop, Microwave

Coffee Maker / Keurig

Sink / Dish Washer

Lounge / Green Room 72" HDTV

Inclosed Patio

Private Restroom

LIVE Video Feed Available

**\$250**

House



CALL

### **BACK LOT WEST**

Private exterior shoot space

2,000+sqft. Private drive, picnic tables

**\$200**

### **WET STAGE**

Pool cleaned & pre-heated to 85 degrees

12hr. day

STAGE A

BACK LOT WEST

Pool ONLY

**\$2,500**

Wet Stage



CALL

### **CREW**

(not required for stage rental)

Production Assistant

General Help / Parking Attendant

**\$30**

hourly

On-Set Studio Tec.

Bridge Crane / Turntable Operator.

Lighting Assistant.

**\$400**

(10 hr)

STAGE B + Pre-lit + 28' Green Screen



Red Gum Studios 2983 E. Miraloma Ave. Anaheim, Ca 92806  
Darin Dormeyer [darin@redgumstudios.com](mailto:darin@redgumstudios.com) mobile/text (714) 458-7003





## Specialty GEAR

(On-site use only.)

### **Automotive Carousel / Turntable (C only)**

In-floor 16' diameter. Remote on / off.  
Variable speed & direction located in platform.

\$550

### **Lightbank 10'x30' (STAGE B or C)**

LED (Tungsten) 24 remote on/off segments

\$750

Flash

10,000 ws 5 Norman packs (10) heads.

\$500

20,000 ws 10 Norman packs (10) heads.

\$650

Flash & LED

\$850

### **Flying Flat 16' x 33' (STAGE B or C)**

\$500

### **Overhead Truss (includes hoists & pre-hung truss)**

32' Truss section

\$150

(4) LED Space Lights. DMX Bicolor + truss.

\$300

**"Pre-lit" Package** (12) LED space lights + (3) truss.

\$750

(Available Truss pieces: 16', 12', bases and corner)

CALL

### **Backdrops (pre-hung)**

**Green Screen** digital green

8'x8' + Frame + (2) High Highs

\$150

28' wide x 12' + truss

\$350

40' wide x 23' + truss + floor strips

\$600

Black Velvet (on-camera black)

(2) 20' x 20' + truss

\$350

**Blackout** (4) 20' x 20' + (3) truss+ floor strips

\$600

Black Painted Floor / Black Floor Strips

CALL

Set Walls, Wall Flats & V Flats

each \$100

### Lightbank + Carousel



### Flying Flat + (L) Lighting Package



### "Pre-lit" Package

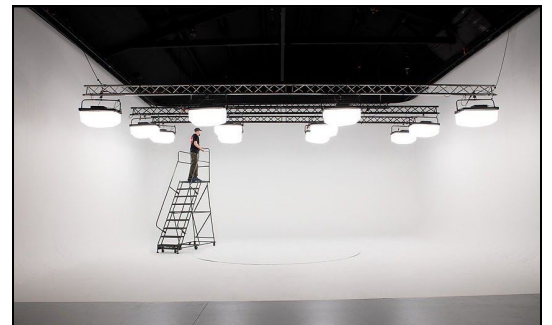

### Set Walls, Flats, Ladders & Stairs





## GEAR Packages

(On-site use only. Individual items also available )

**Production Package** (5) Tables w/ table cloth, (20) chairs. **\$50**

Production Package

### **2 Ton Grip Package**

**\$200**

(4) Combo 3 Riser Rolling Stands, (10) Floor Plates,  
(10) C stands: 20", 30", 40"  
(10+) Flags: minis, 2x3', 30x36", 4x4' Floppies  
(10+) Stingers: 50', 25', 10', splitters.  
(10+) Sand bags: 10 lbs, 20 lbs, 25 lbs, 35 lbs.  
Silks, Apple Boxes, Clamps, Stands, Ladders & more



### **Small ARRI Lighting + 2 Ton Grip Package**

**\$350**

ARRI Fresnels Tungsten /w grids and barn doors.  
(2) 1k, (4) 650, (2) 300, (4) 200 Mole Fresnels

Bi-Color LED Panels

### **Large ARRI Lighting + (S) ARRI + 2 Ton Grip Package**

**\$550**

ARRI Fresnels Tungsten /w grids and barn doors.  
(2) STUDIO 2ks, (3) 2ks, (6) STUDIO 1ks

### **Flash Package**

**\$350**

(8) 640 Einstein Flash units, Sync, Cyber Commander  
(2) 30x60", (2) 10x30" light boxes, 22" Beauty Dish,  
7' retro laser long throw reflector, (8) Stands, Boom.



## LED

(12) **Bi-Color LED Panels** DMX

**\$50**

(also used in "Pre-lit" Package, subject to availability)

each

(6) LITE GEAR 4' Tubes (tungsten),

**CALL**

(4) Westcott Flex LED (tungsten),

MacTEC: (3) 300BI, 200T, Tubes (40+).

**A la Carte GEAR, Expendables, Seamless,  
Speed rail, Cables, MegaBoom, 8' Kino,  
Matthews Doorway Dolly, Studio Stands,  
speakers, Go-jaks and more are available.**

**CALL**





## STAGE A

(2 reserved parking spaces, 7 participants max)

**10 hr. Day** 8am-6pm M-F

**\$400**

**12 hr. Day** Pre-ordered discount rate.

**\$500**

**1,000 sq. ft.**

Outdoor Patio ~20' x 20'

Private Restroom

West Side Cathedral Window 6' x 14'

Access to STAGE B\* & BACK LOT WEST

14' Grid

### **Full Kitchen**

Refrigerator/Freezer/Ice-maker. Sink

Oversize Microwave 30"

Coffee Maker / Keurig

Dish Washer

### **Kitchen Set / Cooking Package**

Rolling Cooktop (propane)

Oversized 30" Oven

Warming Drawer

**Call**

### **Pre-lit\* Backgrounds Package**

**\$200\*+\***

Includes: Background & Fill Lights (Tungsten & Flash).

18' Digital **Green Screen**, Blue screen, Black (drop down)

12' Seamless \*+\*: White, Grey, Blue, Black (drop down)

9' Color Seamless\*+\* : 20+ In-house Colors

\*+\* Damaged Seamless (walked on) = \$5 a linear ft  
5 ft. included in rental.

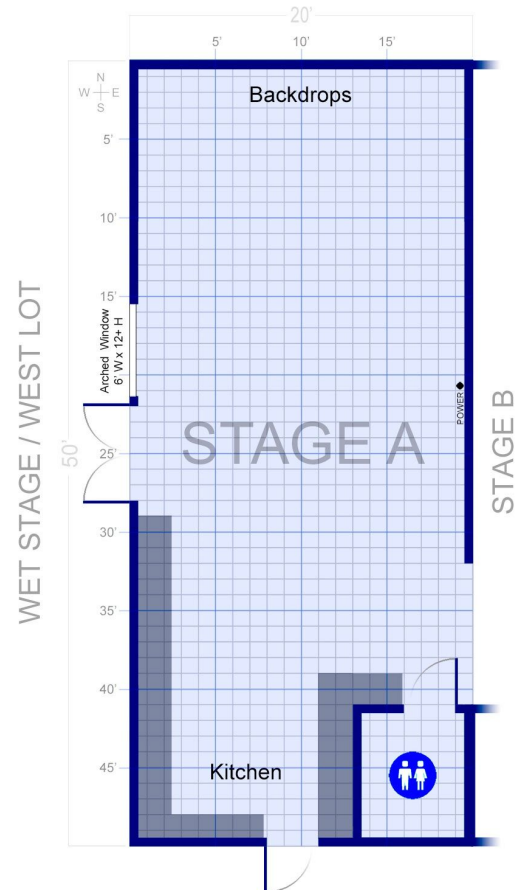

Kitchen





## STAGE B

(4 reserved parking spaces, 14 participants max)

**10 hr. Day** 8am-6pm M-F

**\$600**

**12 hr. Day** Pre-ordered discount rate.

**\$750**

### Pure White Pre-Painted Cove

+ Sticky Mat, Shoe covers & floor cleaner.

30' x 30' Triangle

**\$70**

30' x 30' Square

**\$100**

**2,000sqft.**

~40 wide x ~50 deep

2 Walled 30' x 40' Cyc Curve

14' roll up door

Daylight Window (bolt in)

CALL

**Lightbank, Pre-lit Truss & Packages**

**pg. 5**

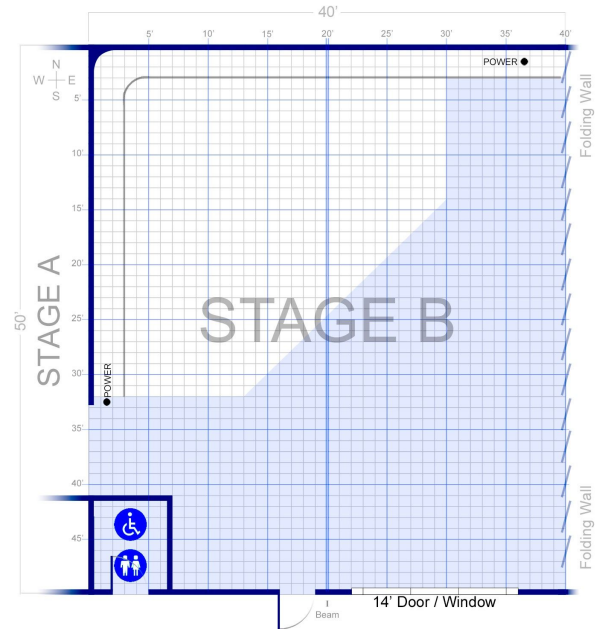

Lightbank



Green Screen + "Pre-lit"







## Stage C

(6 reserved parking spaces, 20 participants max)

|  |                |
|--|----------------|
| <b>10 hr. Day</b> 8am-6pm M-F                | <b>\$1,000</b> |
| <b>12 hr. Day</b> Pre-ordered discount rate. | <b>\$1,250</b> |

### **Pure White Pre-Painted Cove**

+ Sticky Mat, Shoe covers & floor cleaner.

|   |              |
|---|--------------|
| Turntable back                            | <b>\$100</b> |
| 40' x 35' (5' in front of turntable back) | <b>\$150</b> |
| 40' x 40' (10' in front of turntable)     | <b>\$200</b> |

### **Automotive Carousel / Turntable (C only)** **\$550**

In-floor 16' diameter. Remote on / off. Variable speed  
Clockwise / counterclockwise located in platform.

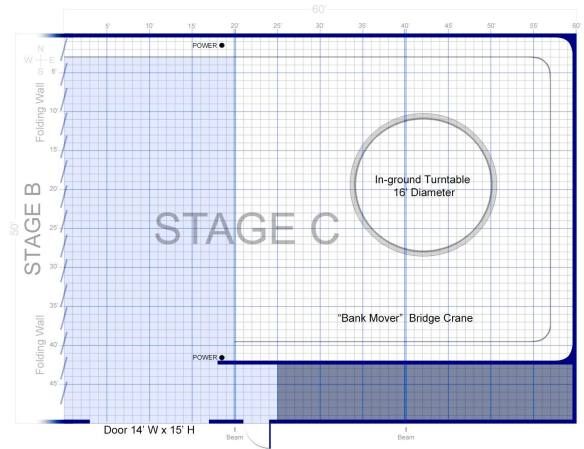

**3,000sqft.** ~50 wide x ~60 deep  
3 Walled 40' x 40' Cyc  
"Bank Mover". Electric Overhead Bridge Crane  
14' roll up door  
**Lightbank or Flying Flat, Pre-lit Truss**

pg. 5

## Stage B+C

(10 reserved parking spaces, 34 participants max)

|  |                |
|--|----------------|
| <b>10 hr. Day</b> 8am-6pm M-F                | <b>\$1,500</b> |
| <b>12 hr. Day</b> Pre-ordered discount rate. | <b>\$1,900</b> |

**5,000sqft.**  
50' x 20' Wall that separates STAGE B & C opened.  
4 Walled curve

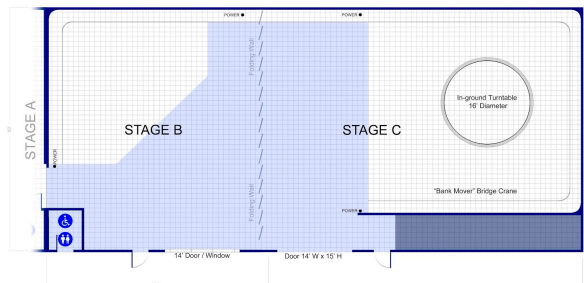

**See STAGE B and C for paint layout, turntable, etc.**



## Rental Agreement

NOTICE: This document makes you responsible for everyone and everything related to your use of the Red Gum Studio property, facilities and equipment, and limits Red Gum Studio's liability to a refund of the rental fee paid.

I the undersigned (the production) do hereby indemnify and hold harmless (the studio) Visual Support Inc. DBAs Red Gum Creative Campus, Red Gum Studios, its employees, agents, assigns and the property owners from any losses, including lost rental fees, repairs or delays caused by my production's use of the equipment or premises.

I am (or employ) a working professional in the industry, knowledgeable in the equipment, suitability, and safety requirements needed for my use. I will check, or have checked, all equipment before use and will report any problems to the studio management for replacement or repair where needed.

### **Red Gum Creative Campus Facility Rules –**

- Work and play well with other productions on the premises.
- Leave the premises, as they were when you arrived.
- Report any problems or damage to the studio management immediately.
- WORK SAFE - Do NOT touch any equipment marked "Authorized personnel only" Reduce your financial liability by calling the staff contact before touching anything you have questions about.
- Limit people to only the production needs.
- To avoid additional charges, DO NOT venture into other studios, outdoor sets, storage areas, or touch other equipment without authorization.

Checklist – What you need before the rental begins:

- ☐ Liability Insurance. (certificate)
- ☐ Signed rental agreement (This form)
- ☐ Payment of rental fees. Payable to Red Gum Creative Campus.

**Limit of Liability** – As a condition of use, the studio's liability for non-performance of any part of the facilities or equipment rental for any reason shall be limited to a refund of any unused rental amount paid. "The Studio" is NOT responsible for any incidental or consequential losses of any kind, for any reason, nor for any vehicles, equipment or property brought to, or left on the premises.

I agree to the above terms and also acknowledge that the studio management may shut down production if any of the terms of rental are breached or for any safety issue, without refund. I further agree that if any portion of this agreement is ruled invalid, the rest of the agreement remains in force.

**Agreed: Signature** \_\_\_\_\_ **Date** \_\_\_\_\_

**Print name** \_\_\_\_\_ **Phone #** \_\_\_\_\_

**Name or ID of Production** \_\_\_\_\_

**Email address:** \_\_\_\_\_